

25: 15 1/2" x 15 3/4"
BB1 - Drawer Bottom

25: 15 1/2" x 15 3/4"
BB1 - Drawer Bottom

25: 15 1/2" x 15 3/4"
BB1 - Drawer Bottom

27: 9 1/2" x 15 3/4"
BB3 - Drawer Bottom

26: 9 1/2" x 13 3/4"
BB2 - Drawer Bottom

26: 9 1/2" x 13 3/4"
BB2 - Drawer Bottom

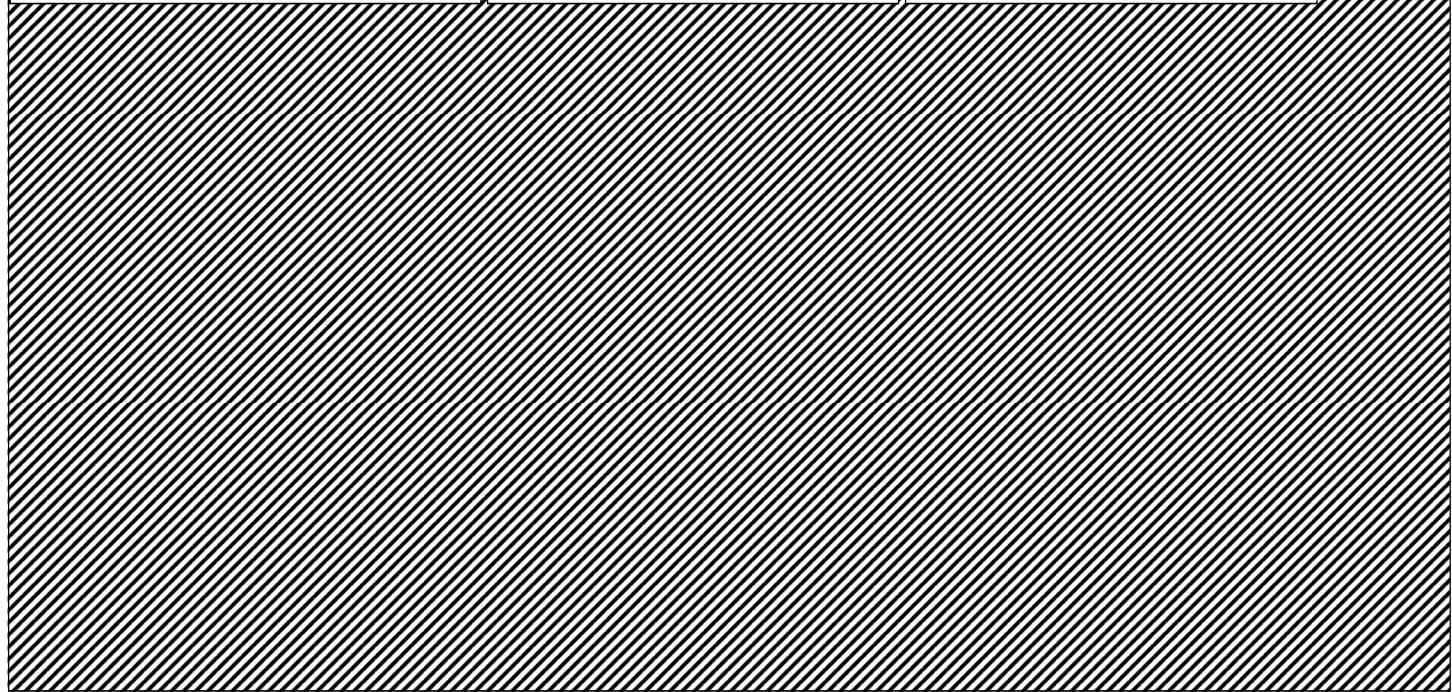

Poplar plywood: 1/4" x 48" x 48" (1 of 1)

Prefer Rip-Cuts

18: 6" x 15 3/4"
DB1 - Drawer Back/Front

18: 6" x 15 3/4"
DB1 - Drawer Back/Front

18: 6" x 15 3/4"
DB1 - Drawer Back/Front

6: 16 7/8" x 14 21/32"
D1 - Door

10: 16 1/2" x 15 7/8"
MS1 - Middle Shelf

24: 3 1/4" x 10"
DS4 - Drawer Side

24: 3 1/4" x 10"
DS4 - Drawer Side

24: 3 1/4" x 10"
DS4 - Drawer Side

24: 3 1/4" x 10"
DS4 - Drawer Side

22: 4 1/2" x 16"
DS2 - Drawer Side

22: 4 1/2" x 16"
DS2 - Drawer Side

2: 4 9/16" x 15 11/32"
DF2 - Drawer Face

22: 4 1/2" x 16"
DS2 - Drawer Side

22: 4 1/2" x 16"
DS2 - Drawer Side

1: 4 1/2" x 15 11/32"
DF1 - Drawer Face

18: 6" x 15 3/4"
DB1 - Drawer Back/Front

19: 4 1/2" x 15 3/4"
DB2 - Drawer Back/Front

20: 3 1/4" x 13 3/4"
DB3 - Drawer Back/Front

20: 3 1/4" x 13 3/4"
DB3 - Drawer Back/Front

19: 4 1/2" x 15 3/4"
DB2 - Drawer Back/Front

19: 4 1/2" x 15 3/4"
DB2 - Drawer Back/Front

20: 3 1/4" x 13 3/4"
DB3 - Drawer Back/Front

19: 4 1/2" x 15 3/4"
DB2 - Drawer Back/Front

20: 3 1/4" x 13 3/4"
DB3 - Drawer Back/Front

Poplar plywood: 1/2" x 48" x 48" (1 of 1)

Standard Layout

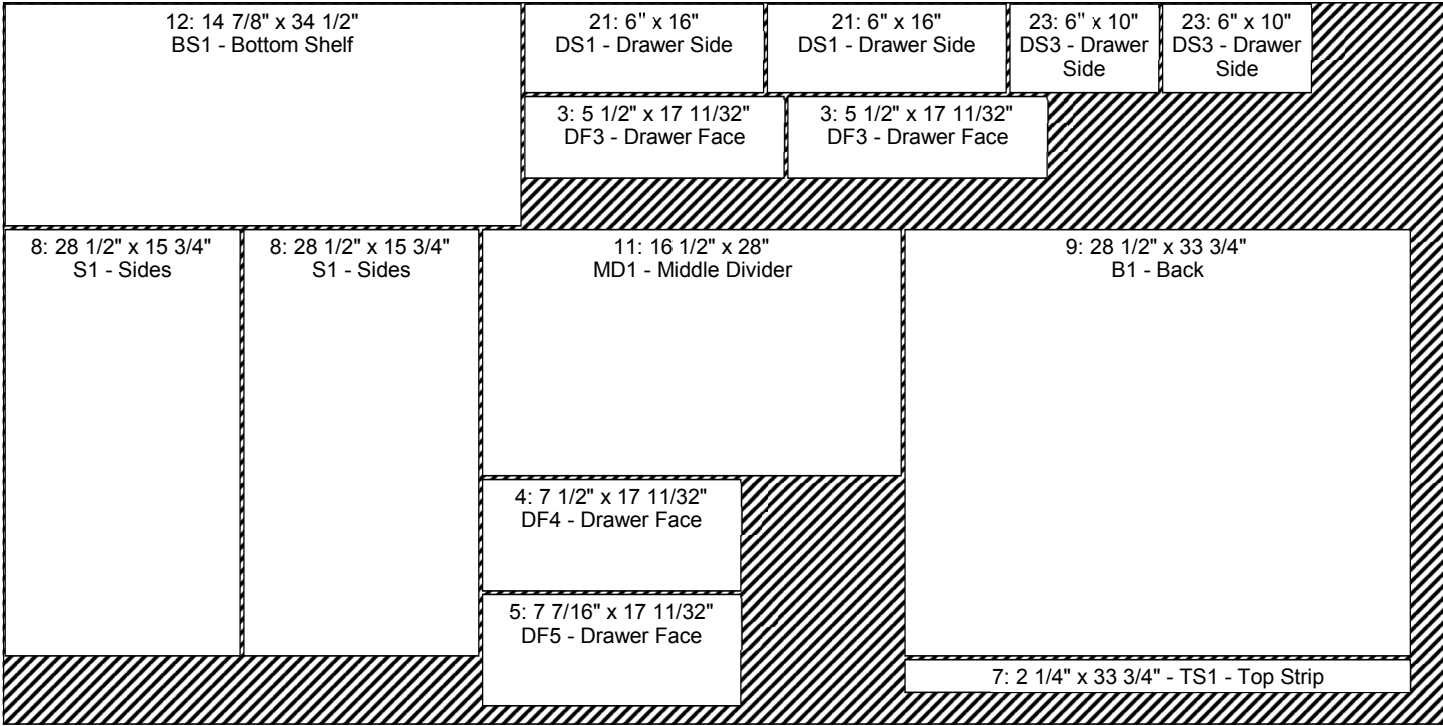

Poplar plywood: 1/2" x 48" x 96" (1 of 1)

Standard Layout

